

OF SHEETS

SHEET NO.	TITLE
1	TYPICAL CROSS SECTIONS
2	ESTIMATE OF QUANTITIES
2	MISCELLANEOUS QUANTITIES
-	RIGHT OF WAY PLAT
3-6	PLAN AND PROFILE STA. 429+00 TO STA. 511+06
7-12	STANDARD DETAILS
-	DRAINAGE STRUCTURES
13-16	CROSS SECTIONS

COUNTY AND HIGHWAY	ROUTE AND SECTION	CLASS AND AGREEMENT	FEDERAL DIVISION OFFICE	SHEET NUMBER	TOTAL SHEETS
70.6	1255.0	11.2	WIS. 4	1	16

STATE OF WISCONSIN
STATE HIGHWAY COMMISSION OF WISCONSIN

PLAN AND PROFILE OF PROPOSED
OSHKOSH - NEENAH ROAD
NORTH SECTION
C.T.H. "A"
WINNEBAGO COUNTY
PROJECT S 1255(2)

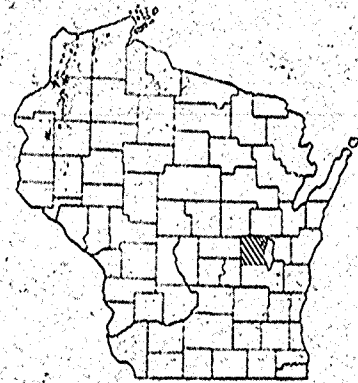

PLAN 1 IN. = 100 FT.
PROFILE HOR. 1 IN. = 100 FT. VERT. 1 IN. = 10 FT.
CROSS SECTIONS HOR. 1 IN. = 5 FT. VERT. 1 IN. = 5 FT.

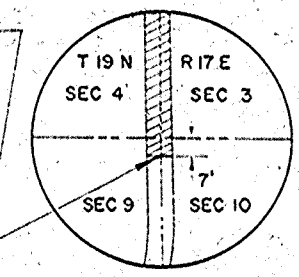
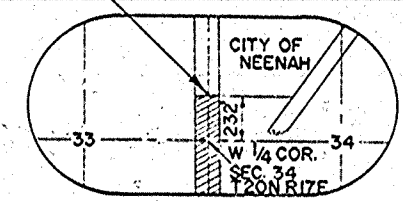
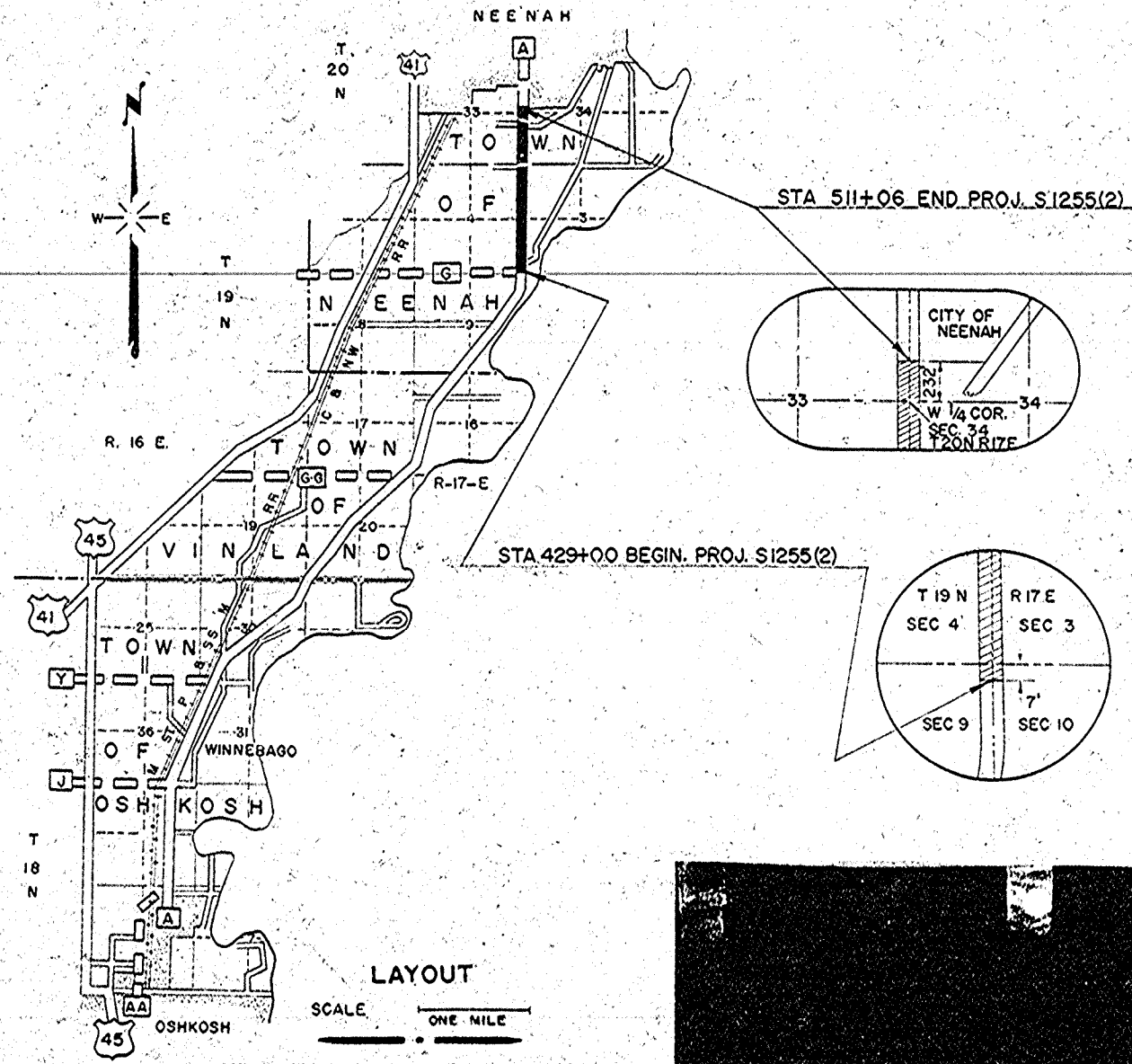

CONVENTIONAL SIGNS

STATE LINE	-----	CULVERTS IN PLACE	-----
COUNTY LINE	-----	CULVERTS REQUIRED	-----
TOWNSHIP OR RANGE LINE	-----	DROP INLET	-----
SECTION LINE	-----	POWER POLE	-----
NEW RIGHT OF WAY LINE	-----	TELEPHONE OR TELEGRAPH POLE	-----
PRESENT RIGHT OF WAY LINE	-----	RIGHT OF WAY MARKERS	-----
WIRE FENCE (WOVEN)	-----	REFERENCE STAKE FOR HUBS ONLY	-----
WIRE FENCE (BARBED)	-----	MARSH	-----
LOT LINE	-----	HEDGE	-----
CORPORATE OR CITY LIMITS	-----	TREES	-----
PROPERTY LINE	-----	GROUND ELEVATION	-----
TRAVELED WAY OR P.E.	-----	GRADE ELEVATION	-----
RAILROADS	-----		
BASE OR SURVEY LINE	-----		

LAYOUT

SCALE ONE MILE

TOTAL NET LENGTH OF CENTERLINE = 1.554 MI.

STATE HIGHWAY COMMISSION OF WISCONSIN
MADISON, WIS.

DESIGNED BY: N.L.C. (NOTE BOOK 10649-10650)
CHECKED BY: L.J.L., R.L.B. (CHECKER)
DRAWN BY: C.P.K. (CONTRACTOR)

CORRECTED DATE: 12/20/56

RECOMMENDED FOR APPROVAL: [Signature]

DATE: 1-18-57 [Signature]

APPROVED: [Signature]

DATE: 1/10/57 [Signature]

DEPARTMENT OF COMMERCE
BUREAU OF PUBLIC ROADS

APPROVED: [Signature]

S 1255(2)

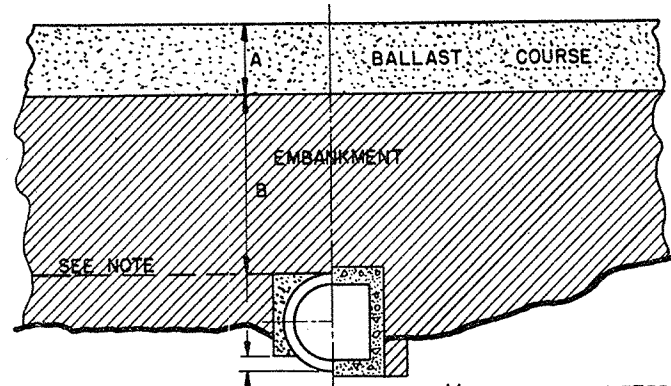

HALF SECTION - PIPE CULVERTS HALF SECTION - BOX CULVERTS

TREATMENT WHEN A+B IS OVER 5 FT.

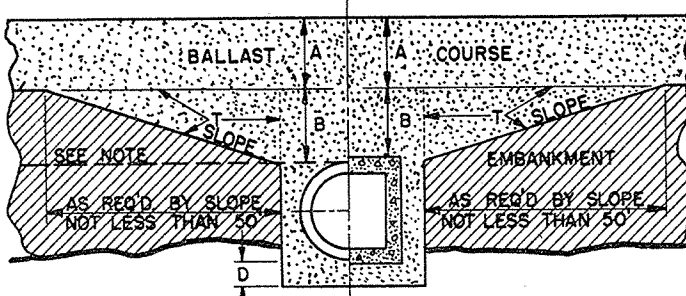

HALF SECTION - PIPE CULVERTS HALF SECTION - BOX CULVERTS

TREATMENT WHEN A+B IS FROM 0 TO 5 FT.
SLOPE: NOT STEEPER THAN 25:1

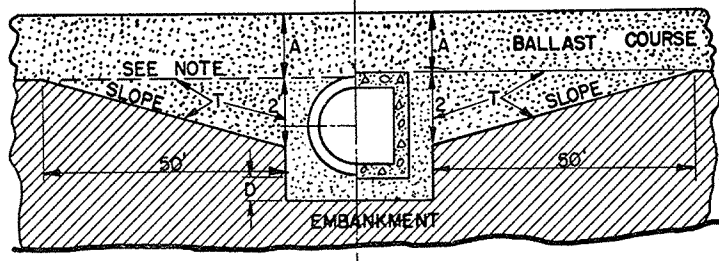

HALF SECTION - PIPE CULVERTS HALF SECTION - BOX CULVERTS

TREATMENT WHEN B = 0
SLOPE: NOT STEEPER THAN 25:1

GENERAL NOTES

DETAILS OF CONSTRUCTION NOT SHOWN HERE SHALL CONFORM TO THE PERTINENT REQUIREMENTS OF THE STANDARD SPECIFICATIONS AND THE APPLICABLE SPECIAL PROVISIONS.

DETAILS ARE NOT APPLICABLE FOR PRIVATE ENTRANCE CULVERTS.

DETAILS APPLY TO BOTH PIPE AND CONCRETE BOX CULVERTS UNLESS OTHERWISE SHOWN ON OTHER PARTS OF THE PLAN OR IN THE CONTRACT.

EXCAVATION FOR AREAS MARKED "t" WILL BE PAID FOR AT THE CONTRACT UNIT PRICES FOR PERTINENT ITEMS OF "ROADWAY AND DRAINAGE EXCAVATION," WHEN SUCH EXCAVATION CONSISTS OF MATERIAL NOT PLACED UNDER THE CURRENT CONTRACT. BACKFILL IN THESE AREAS TO BE PAID FOR AT THE PERTINENT UNIT PRICE BID FOR "SAND GRAVEL FILL" OR FOR MATERIAL USED.

THE ELEVATION OF THE EXISTING GROUND OR PREVIOUSLY PLACED AND COMPACTED EMBANKMENT SHALL BE AT LEAST IN THE PLANE OF THE

TOP OF THE PROPOSED CULVERT PRIOR TO EXCAVATING THE TRENCH.

IN THE CASE OF CONCRETE BOX CULVERTS, THE EXCAVATION BELOW THE BOTTOM AND NECESSARY TO PREPARE THE TRENCH WILL BE MEASURED AND PAID FOR AT THE CONTRACT UNIT PRICE BID PER CUBIC YARD FOR "EXCAVATION FOR STRUCTURES, CULVERTS."

IN THE CASE OF PIPE CULVERTS, ALL EXCAVATION FOR FORMING THE BED SHALL BE INCLUDED IN THE CONTRACT UNIT PRICE PER LINEAR FOOT OF THE SEVERAL TYPES AND SIZES OF CULVERT PIPE.

IN EITHER CASE, BACK FILL WILL BE PAID FOR AT THE PERTINENT CONTRACT PRICE FOR THE MATERIAL USED.

- A - DEPTH OF BALLAST COURSE.
- B - DISTANCE FROM TOP OF CULVERT TO BOTTOM OF BALLAST.
- D - VARIABLE. DEPTH OF BALLAST BELOW CULVERT. MINIMUM-12"

F - DISTANCE FROM FINISHED SURFACE TO STREAM BED.

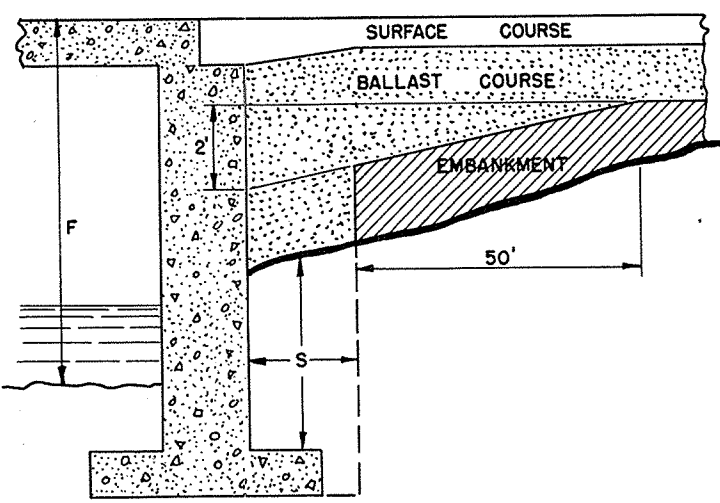

TREATMENT WHEN F IS LESS THAN 10 FT.

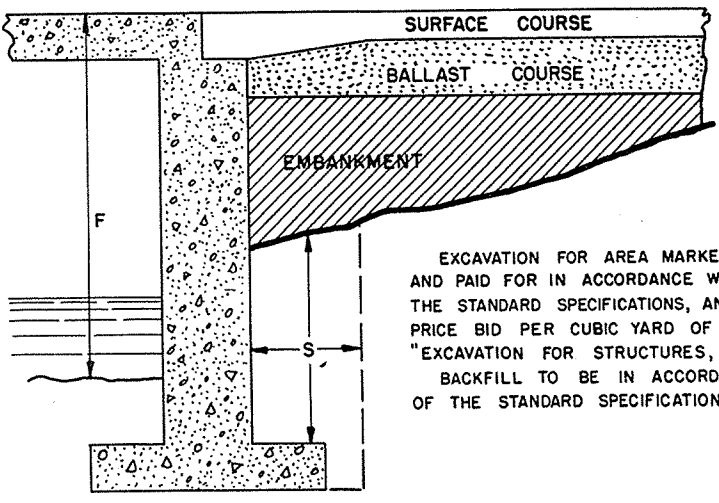

TREATMENT WHEN F IS 10 FT. OR MORE.

EXCAVATION FOR AREA MARKED "s" SHALL BE MEASURED AND PAID FOR IN ACCORDANCE WITH SECTION 2107.04 OF THE STANDARD SPECIFICATIONS, AND AT THE CONTRACT UNIT PRICE BID PER CUBIC YARD OF ORIGINAL VOLUME FOR "EXCAVATION FOR STRUCTURES, BRIDGES."
BACKFILL TO BE IN ACCORDANCE WITH SECTION 2107.03 OF THE STANDARD SPECIFICATIONS.

EXCAVATION AND BACKFILL FOR PIPE CULVERTS - BOX CULVERTS ABUTMENTS

STATE HIGHWAY COMMISSION OF WISCONSIN

RECOMMENDED FOR APPROVAL:

Frank Moran
DESIGN ENGINEER

Ed. Bluh
CONSTRUCTION ENGINEER

APPROVED OCT. 1, 1945

DRAWN N.F.C.
CHECKED E.C.

E.C. Rettig
STATE HIGHWAY ENGINEER

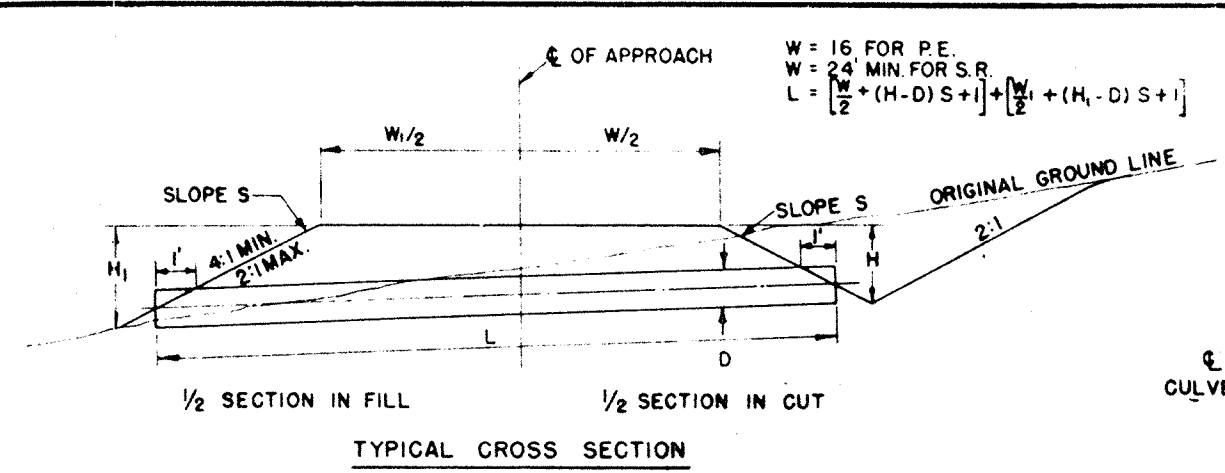

TYPICAL CROSS SECTION

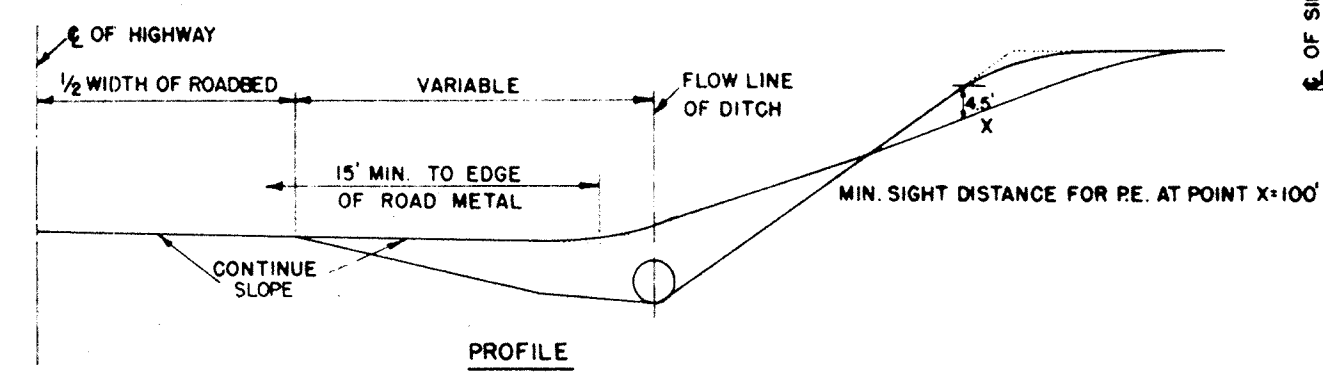

PROFILE

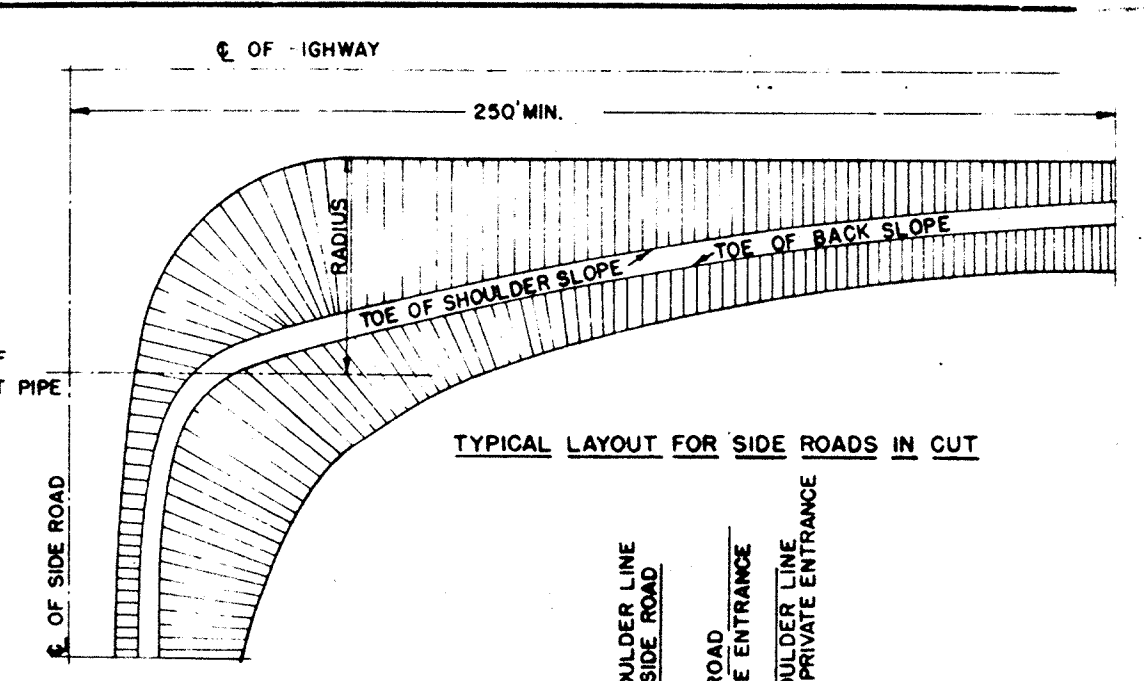

TYPICAL LAYOUT FOR SIDE ROADS IN CUT

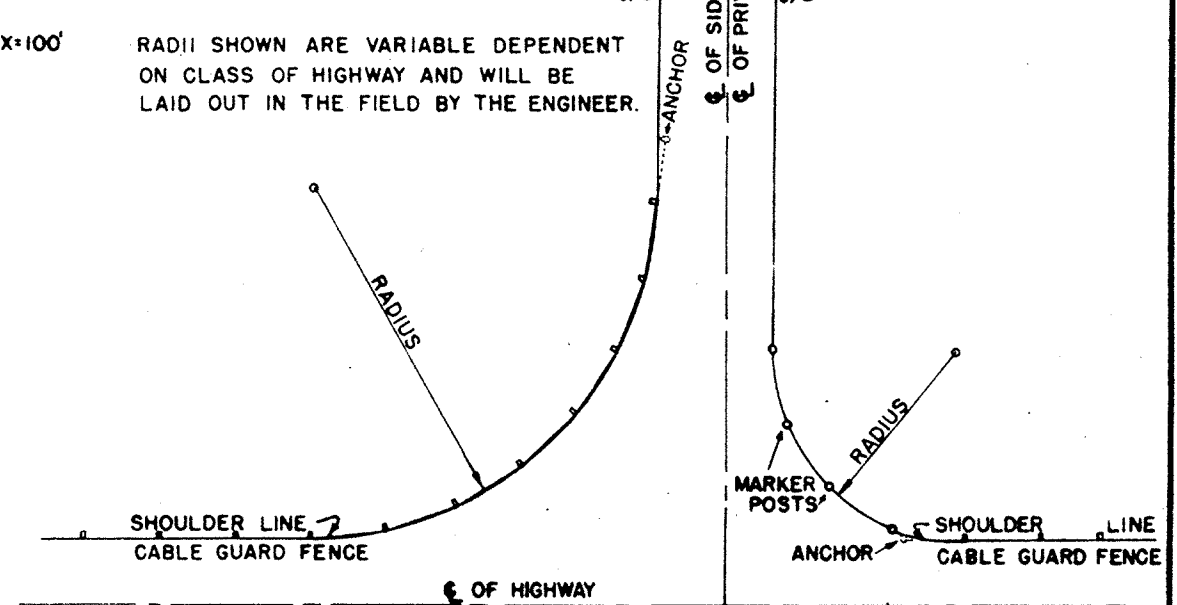

TYPICAL LAYOUT FOR PRIVATE ENTRANCES AND SIDE ROADS IN HIGH FILLS

DETAILS OF PRIVATE ENTRANCE AND SIDE ROAD APPROACHES	
STATE HIGHWAY COMMISSION OF WISC.	
RECOMMENDED FOR APPROVAL:	
<i>Frank Crow</i> DESIGN ENGINEER	
<i>M. Bluh</i> CONSTRUCTION ENGINEER	
DATE	OCT. 1, 1945
APPROVED	<i>R. L. Roach</i> 3 STATE HIGHWAY ENGINEER
DRAWN	
CHECKED	

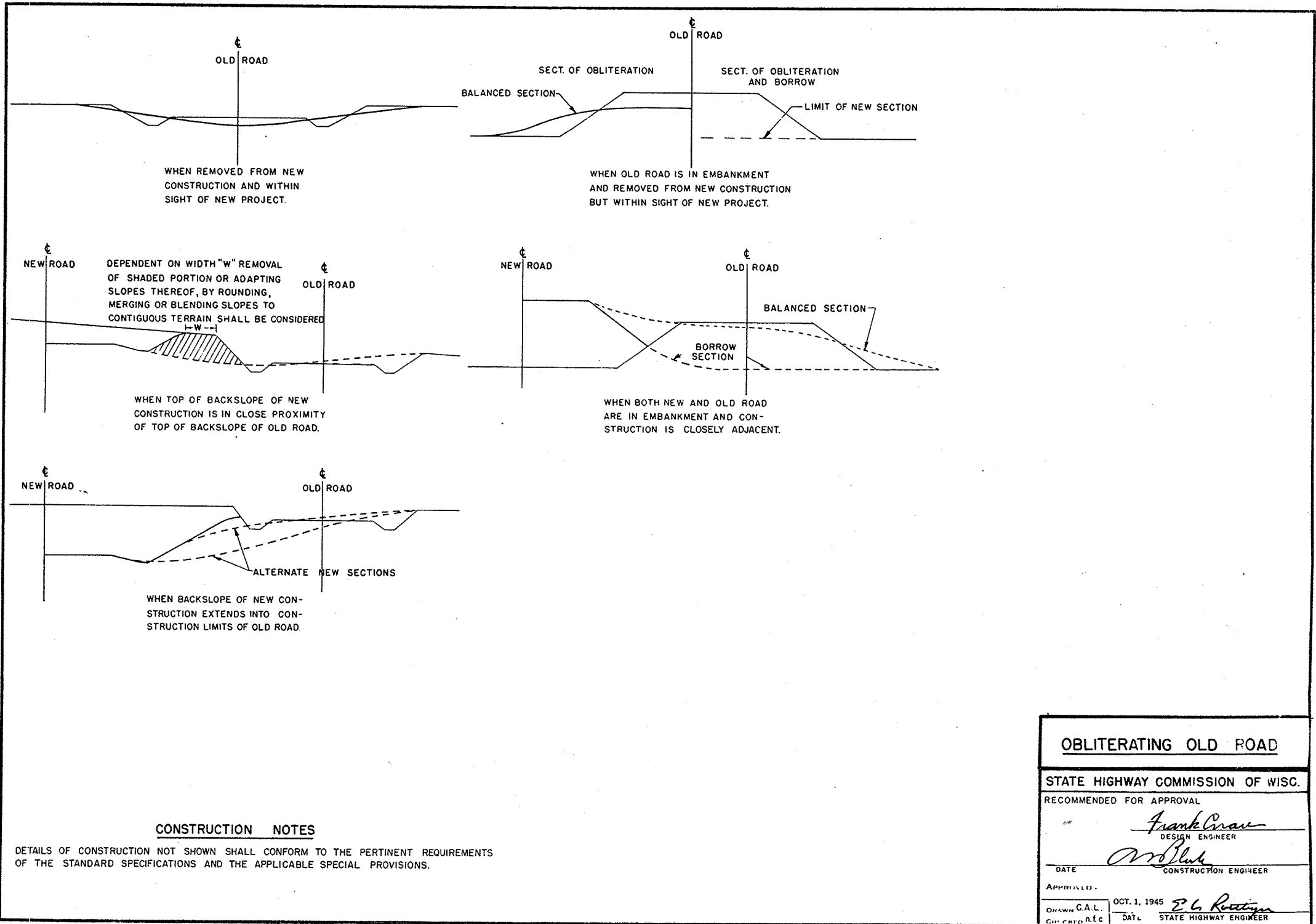

CONSTRUCTION NOTES

DETAILS OF CONSTRUCTION NOT SHOWN SHALL CONFORM TO THE PERTINENT REQUIREMENTS OF THE STANDARD SPECIFICATIONS AND THE APPLICABLE SPECIAL PROVISIONS.

OBLITERATING OLD ROAD	
STATE HIGHWAY COMMISSION OF WISC.	
RECOMMENDED FOR APPROVAL	
<i>Frank Crow</i> DESIGN ENGINEER	
<i>W. Bluh</i> CONSTRUCTION ENGINEER	
DATE	
APPROVED	
DRAWN C.A.L.	OCT. 1. 1945
CHECKED R.E.C.	<i>E. G. Reisinger</i> STATE HIGHWAY ENGINEER

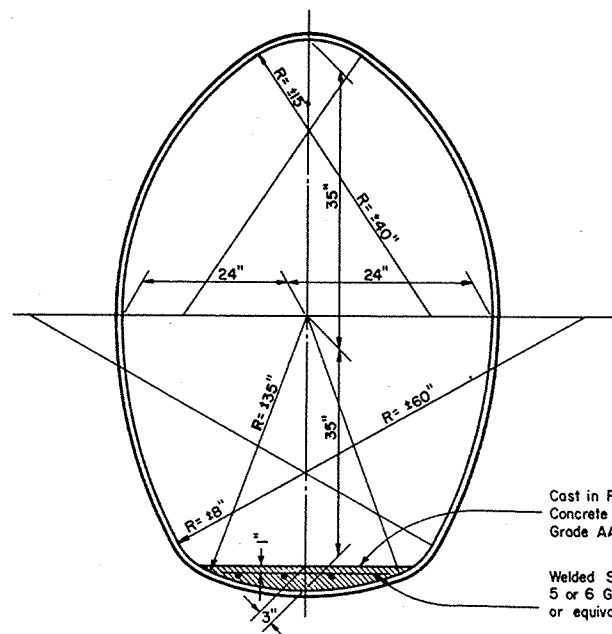

**CORRUGATED METAL PIPE
CATTLE PASS**
(10 Gage Metal)

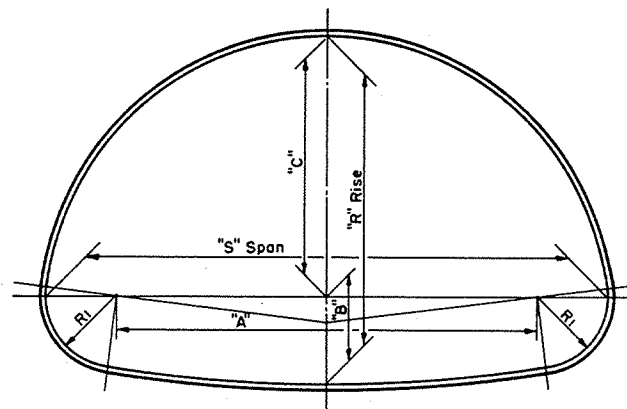

CORRUGATED METAL PIPE ARCH
(Riveted)

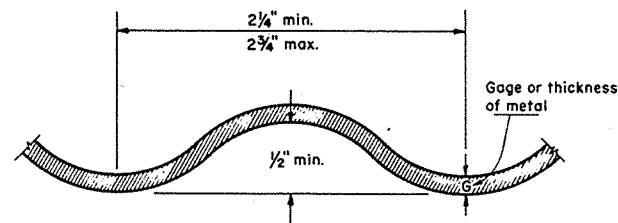

DETAIL OF METAL CORRUGATIONS

TABLE OF DIMENSIONS

Gauge (Min. Accept- able)	CORRUGATED METAL PIPE ARCH								Round Pipe of Approx. Equal Periphery	
	"S" Span Inches	"R" Rise Inches	"A" Inches	"B" Inches	"C" Inches	"R1" Inches	R/S Ratio	Area Sq. Ft.	Area Sq. Ft.	Diam Inches
16	18	11	10	4 1/2	6 1/2	3 1/2	.61	1.1	1.23	15
16	22	13	14	4 3/4	8 1/4	4	.59	1.6	1.77	18
16	25	16	17	5 1/4	10 3/4	4	.64	2.2	2.41	21
14	29	18	20	5 1/2	12 1/2	4 1/2	.62	2.8	3.14	24
14	36	22	26	6 1/4	15 3/4	5	.61	4.4	4.91	30
12	43	27	32	7	20	5 1/2	.63	6.4	7.07	36
12	50	31	38	8	23	6	.62	8.7	9.62	42
12	58	36	44	9 1/4	26 3/4	7	.62	11.4	12.57	48
12	65	40	49	10 1/2	29 1/2	8	.62	14.3	15.90	54
10	72	44	54	11 3/4	32 1/4	9	.61	17.6	19.64	60

NOTE: All Dimensions measured from inside crest of corrugations.

GENERAL NOTES

Details of construction not shown on this drawing shall conform to the pertinent requirements of the Standard Specifications, Sections 2411 and 4116 and the applicable Special Provisions.

TOLERANCES

Tolerance from the dimensions detailing size and shape will be permissible providing equivalent capacity and strength are attained.

EMBANKMENT - Minimum for $\frac{1}{2}$ Culverts

For Flexible Type Pavement, the minimum depth of embankment or cover over top of Pipe Arch (finished construction) shall be "S"/10 or 9" minimum.

For Rigid Type Pavement, the minimum depth of embankment over top of Pipe Arch shall be "S"/14 or a minimum of 3" cushion between pipe and pavement.

EMBANKMENT - Maximum for $\frac{1}{2}$ Culverts

The maximum depth of embankment shall be 10 feet (finished construction).

Adequate cover protection for all Cattle Passes and Pipe Arches shall be provided at all times during construction operations to preclude any damage to structures.

BID ITEMS

No. 2411-51 Corr. Metal Pipe Arch (Size) Lin. Ft.
No. 2411-61 Corr. Metal Pipe Cattle Pass (48"x70") Lin. Ft.

**CORRUGATED METAL
PIPE CATTLE PASS &
PIPE ARCH**

STATE HIGHWAY COMMISSION OF WISCONSIN

RECOMMENDED FOR APPROVAL

5/5/55
DATE

APPROVED:

5/5/55
DATE

J. J. Pelt
ENGINEER OF DESIGN

E. C. Rostetter
STATE HIGHWAY ENGINEER

PLATE NO. 6-5.1.4

5

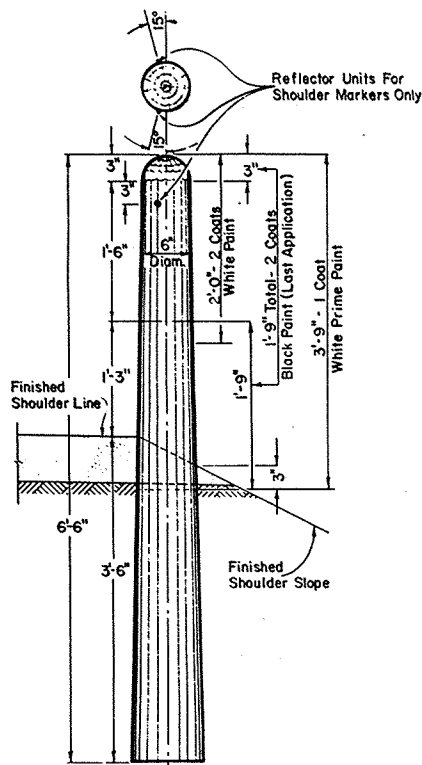

MARKER POST FOR ROAD SHOULDERS AND CULVERTS

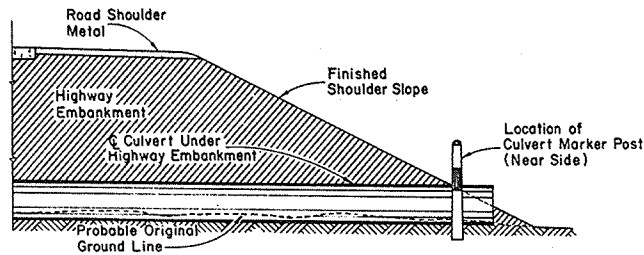

SECTION SHOWING RELATIVE LOCATION OF MARKER POST FOR CULVERTS

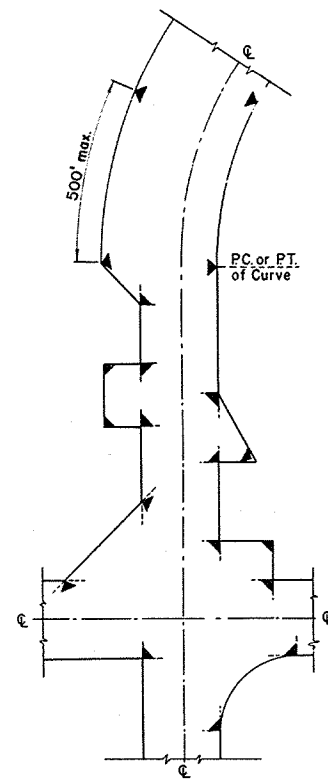

LOCATION DIAGRAM SHOWING TYPICAL LOCATIONS OF MARKER POSTS FOR RIGHT OF WAY

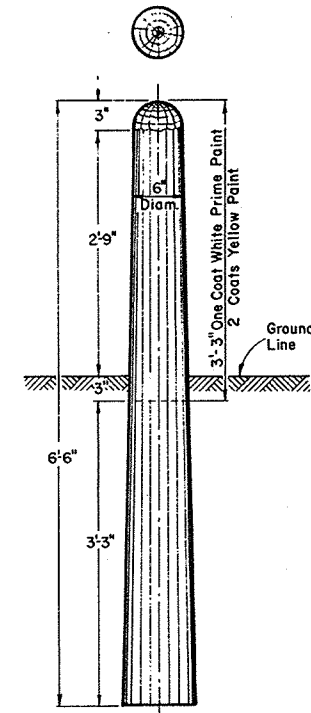

MARKER POST FOR RIGHT OF WAY

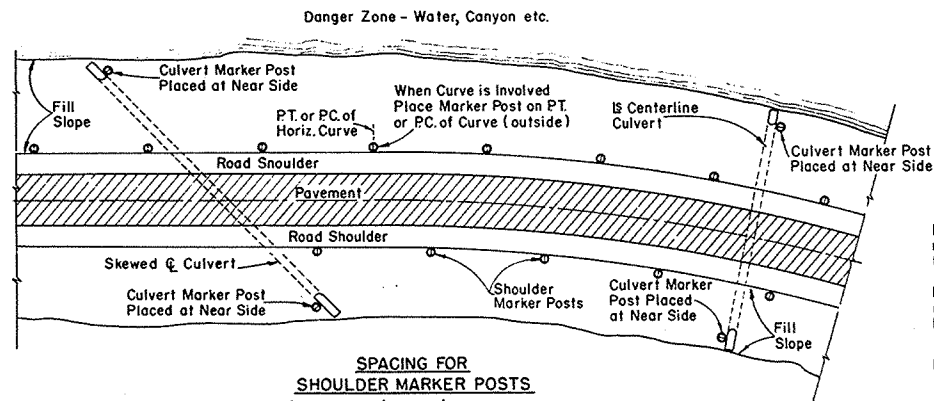

SPACING FOR SHOULDER MARKER POSTS
50' C:C for 100' to 500' Danger Zones
100' C:C for Over 500' Danger Zones

LOCATION DIAGRAM SHOWING RELATIVE LOCATIONS OF SHOULDER MARKER POSTS AND CULVERT MARKER POSTS

MARKER POSTS FOR ROAD SHOULDERS AND CULVERTS

MARKER POST FOR RIGHT OF WAY

GENERAL NOTES:

Details of Construction not shown on this drawing shall conform to the pertinent requirements of the Standard Specifications Sections 2523, 4124 and 4125 and the applicable Special Provisions.
All posts for Road Shoulder Markers, Culvert Markers and Right of Way Markers are identical except for Painting and Reflector Units. All Posts shall be round and untreated and shall be either Northern White Cedar, Southern Yellow Pine, Norway Pine, White Pine or Jack Pine.

MARKER POSTS FOR RIGHT OF WAY

Right of Way Marker Posts shall be erected in advance of Grading Operations. Posts may be shaped and painted prior to erection. Any damaged areas occurring to paint surface during erection or other subsequent operations must be repainted prior to acceptance.

Posts shall be placed at the outer limits of the Highway Right of Way, but entirely within the Right of Way and shall be so placed that the outer edge of the posts shall be tangent to the Right of Way line or lines extended. The exact location of all Right of Way Posts shall be staked in the field by the Engineer.

REFLECTOR UNITS

Reflector Units shall have plastic crystal lens 7/8" in diameter. Unit assembly shall be a minimum of 7/8" in length. Reflector Units shall be furnished with flared expanding metal clips for wood mounting. Units shall be mounted in tightest fit possible and securely stayed in posts. Reflector Units shall be installed in Road Shoulder Marker Posts only.

BID ITEMS

No. 2523-3 Marker PostsEach
No. 2523-4 Marker Posts for Right of Way.....Each

MARKER POSTS & MARKER POSTS FOR RIGHT OF WAY

STATE HIGHWAY COMMISSION OF WISCONSIN

RECOMMENDED FOR APPROVAL

4/6/54
DATE

J. Pelt
ENGINEER OF DESIGN

APPROVED:

11/27/57
DATE

E. L. Hillman
STATE HIGHWAY ENGINEER

PLATE NO. 7-1.3.2.

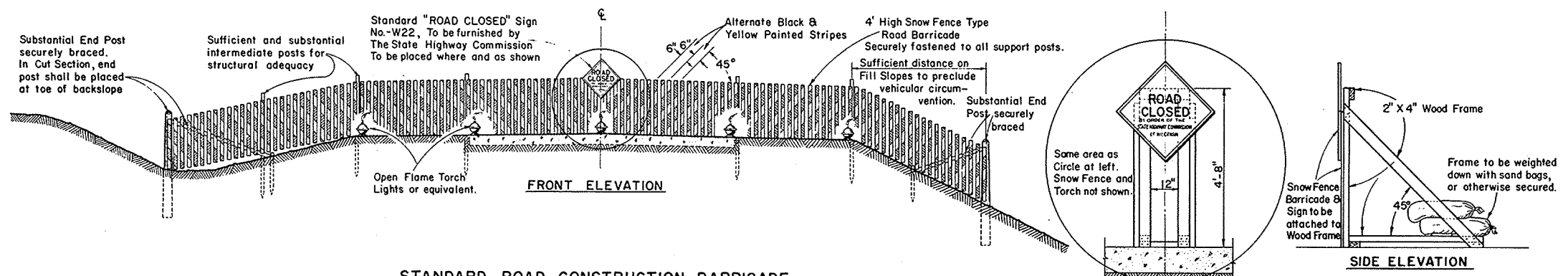

STANDARD ROAD CONSTRUCTION BARRICADE

SNOW FENCE TYPE-"A"

**WOOD FRAME SUPPORT AT C
FOR SNOWFENCE TYPE BARRICADE
When Barricade is Erected on Rigid Type Surfacing**

GENERAL NOTES

The Contractor shall construct, place and maintain barricades as shown on this drawing and as required by the Standard Specifications Section 1107 for the duration of the project. Barricades shall be painted and structurally maintained for maximum visibility at all times.
Provision shall be made in the construction of barricades to provide for ingress and egress for local access as may be required.

ALTERNATE DESIGNS

Contractors may submit to the Engineer for approval, designs for Barricades other than shown on this drawing, and upon the Engineer's approval may be used as alternates.

MEASUREMENT & PAYMENT

All Barricades, unless otherwise provided for in the Plans and/or Special Provisions shall be furnished, placed, and maintained as noted above, and no additional compensation will be allowed but shall be construed to be included in the price bid for other items.

CONSTRUCTION BARRICADE	
<i>STATE HIGHWAY COMMISSION OF WISCONSIN</i>	
RECOMMENDED FOR APPROVAL:	
DATE <i>4/2/55</i>	<i>J. d. Peltz</i> ENGINEER OF DESIGN
APPROVED:	
DATE <i>6/4/55</i>	<i>E. C. Ruettinger</i> STATE HIGHWAY ENGINEER

BENCH MARKS				
NO.	STATION	DESCRIPTION	ANGLE	ELEV.
15	416+70	PTMK SE COR GAS ISLAND	40' LT	95.66
16	420+60	SPIKE IN 20" BOX ELDER	54' RT	93.54
17	428+18	" " 20" ELM	49' LT	92.02
18	469+03	" " POWER POLE	33' RT	102.85
19	475+82	" " 18" TW ELM	120' RT	103.33

SURVEY CURVE NOTES
 P.I. = 420+50
 L = 142'-10"
 Δ = 37°-50'
 D = 5°-30'
 T = 357.13
 L.C. = 687.88
 S.E. = 065°/FT

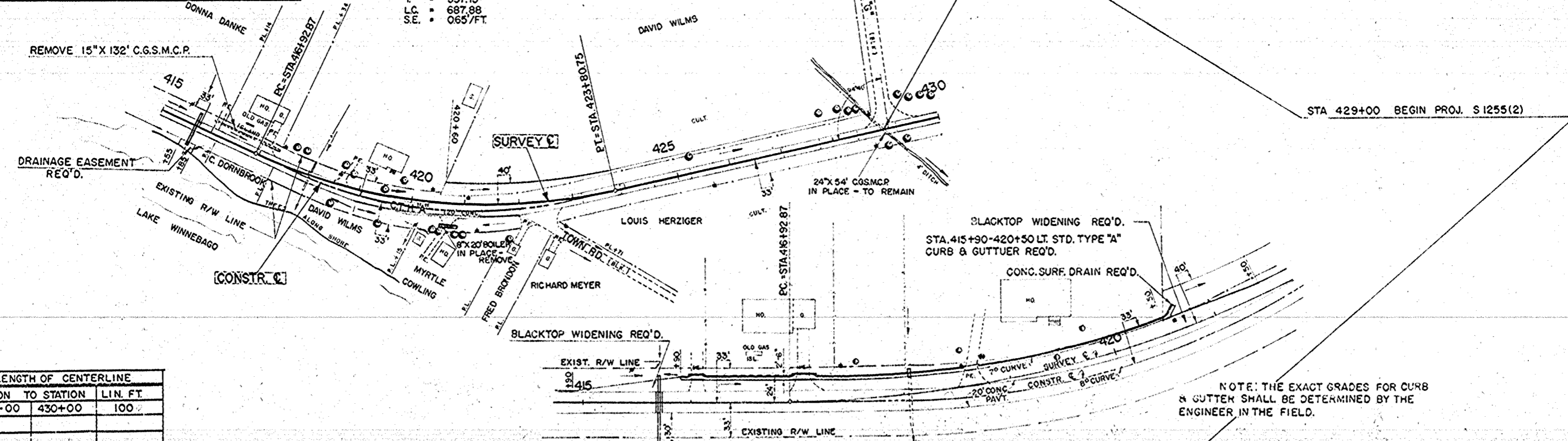

NET LENGTH OF CENTERLINE		
STATION TO STATION	LIN. FT.	
429+00	430+00	100

NOTE: THE EXACT GRADES FOR CURB & GUTTER SHALL BE DETERMINED BY THE ENGINEER IN THE FIELD.

DETAILS SHOWING CURB & GUTTER & BLACKTOP WIDENINGS, STA. 414+90-421+50

GENERAL NOTES
 THE EXACT LOCATIONS OF PRIVATE ENTRANCE PIPES SHALL BE DETERMINED BY THE ENGINEER IN THE FIELD.
 CY. OF FILL AS SHOWN ON THIS PLAN PERTAINS TO EMBANKMENT CONSTRUCTED FROM UNCLASSIFIED EXCAVATION THE SHRINKAGE ALLOWANCE VARIES FROM 20-55%.

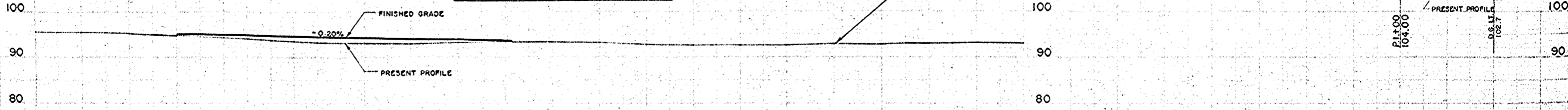
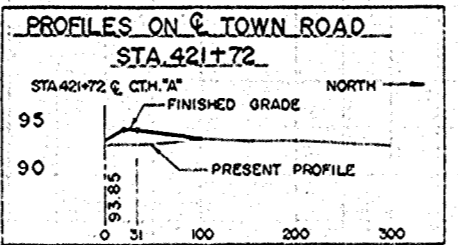

STA. 415+70
24"X64' CULV. PIPE REQ'D.

STA. 418+04
18"X46' CULV. PIPE IN PLACE
EXTEND LT. 18'

LEGEND
 UNC. EXC. UNCLASSIFIED EXCAVATION
 P.L. PROPERTY LINE
 P.E. PRIVATE ENTRANCE
 D.G. DITCH GRADE
 T. TELEPHONE POLE
 P. POWER POLE
 OBL. OBLITERATE OLD ROAD
 PAVT. REMOVAL

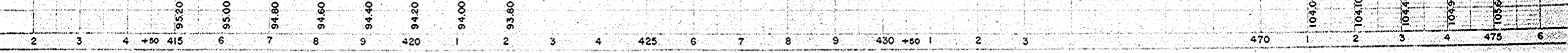

N.L.C. 3-56
 W.R.K. 3-56
 10669

N.L.C. 3-56
 W.R.K. 3-56
 10650

BENCH MARKS			
NO.	STATION	DESCRIPTION	ELEV.
19	475+82	SPIKE IN 18" TWIN ELM 120' RT.	103.33
20	494+15	" " 18" MAPLE 45' LT.	101.25
21	500+00	" " 15" B. ELDER 70' LT.	101.71

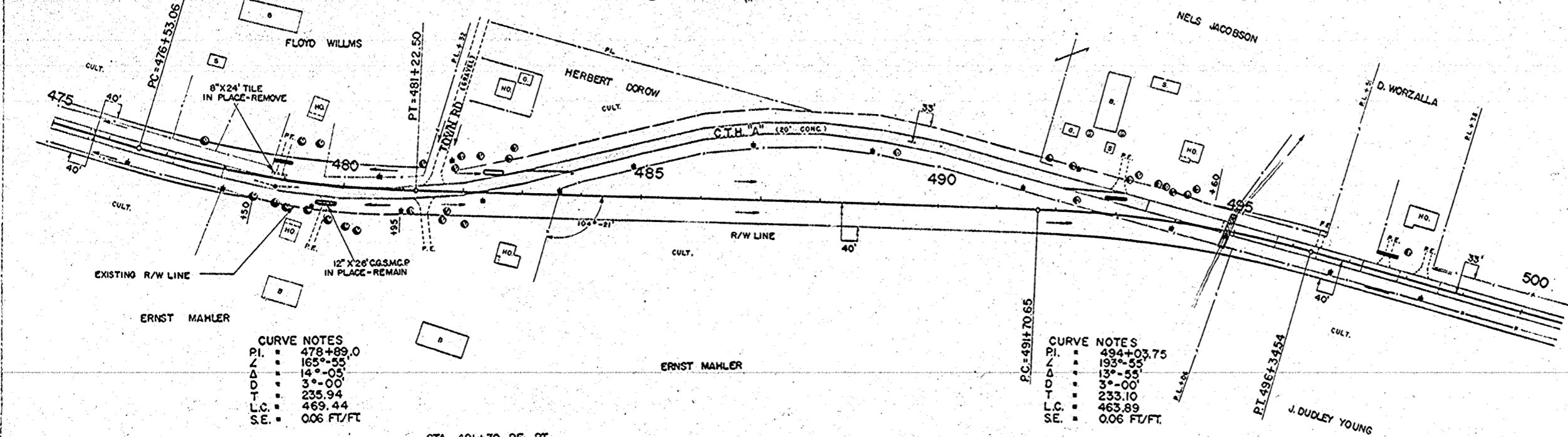

CURVE NOTES
 P.I. 478+89.0
 L 165'-05"
 Δ 14°-05"
 D 3°-00"
 T 235.94
 L.C. 469.44
 S.E. 0.06 FT/FT

CURVE NOTES
 P.I. 494+03.75
 L 135'-55"
 Δ 13°-55"
 D 3°-00"
 T 233.10
 L.C. 463.89
 S.E. 0.06 FT/FT

NET LENGTH OF CENTERLINE		
STATION TO STATION	LIN. FT.	
474+00	500+00	2600.0

STA. 481+30 RE. RT. ENTRANCE GRADE RECD.

STATION	UNC. EXC.	FILL	USE
475+00	423 C.Y.	362 C.Y.	43 C.Y. OLD CONC.
481+30	1402 C.Y.	1259 C.Y.	217 C.Y. OLD CONC.
499+00	231 C.Y.	1063 C.Y.	24 C.Y. OLD CONC. / 1365 C.Y. BORROW

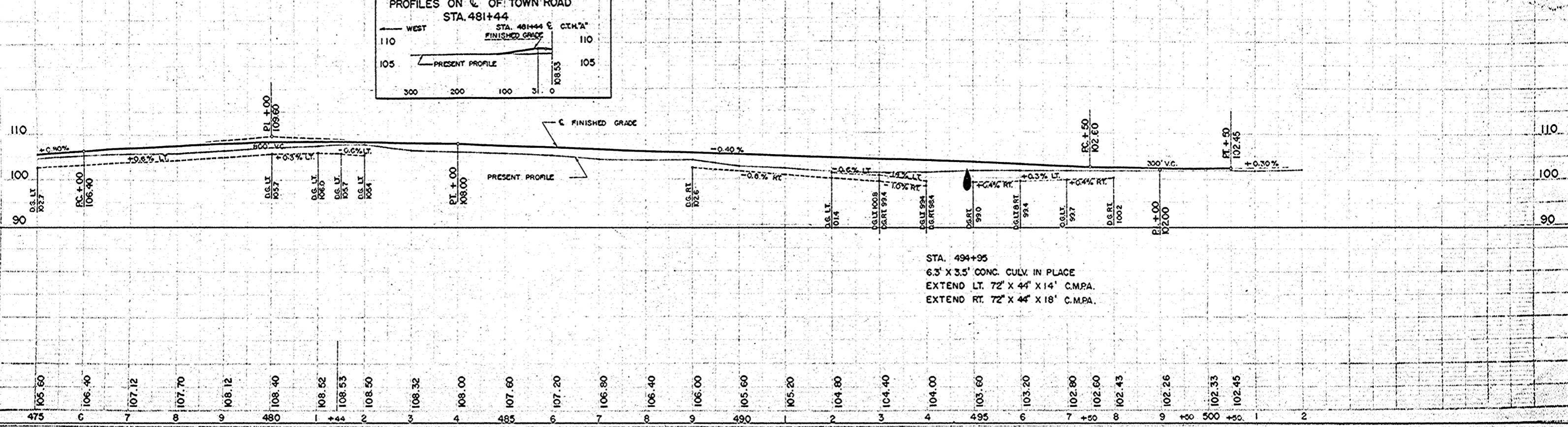
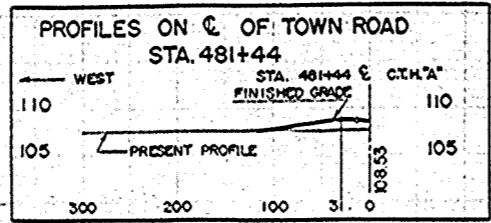

STA. 494+95
 6.3' X 3.5' CONC. CULV. IN PLACE
 EXTEND LT. 72' X 44' X 14' C.M.P.A.
 EXTEND RT. 72' X 44' X 18' C.M.P.A.

PLAN
 10649

10650

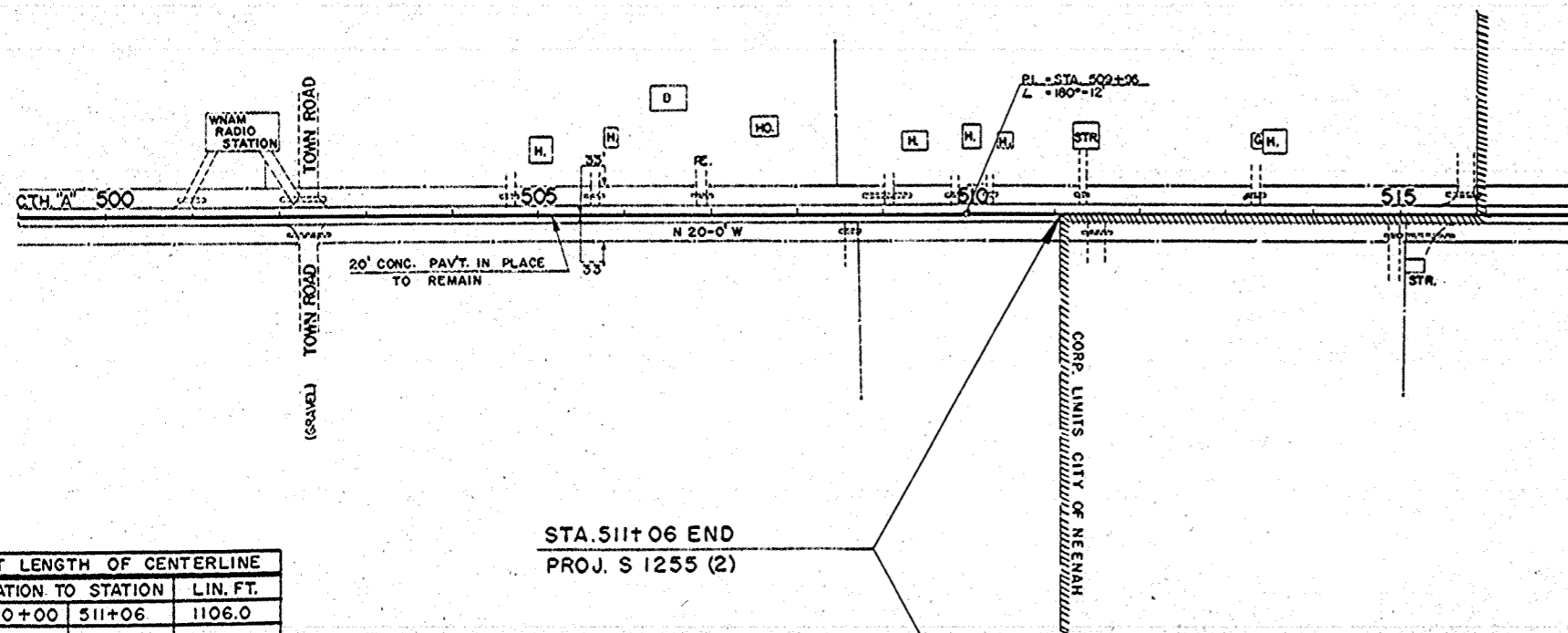

STA. 511+06 END
PROJ. S 1255 (2)

NET LENGTH OF CENTERLINE		
STATION TO STATION	LIN. FT.	
500+00	511+06	1106.0

PLAN
DATE: 10/28/59
BY: M.C. W.B.C.
CHECKED: M.C. W.B.C.
DATE: 11/11/59

PROFILE
DATE: 10/28/59
BY: M.C. W.B.C.
CHECKED: M.C. W.B.C.
DATE: 11/11/59

9 500 1 2 3 4 505 6 7 8 9 510 1 2 3 4 515 6 7

FINAL SURVEY NOTEBOOK No. 10650

ORIGINAL SURVEY NOTES No. 10650

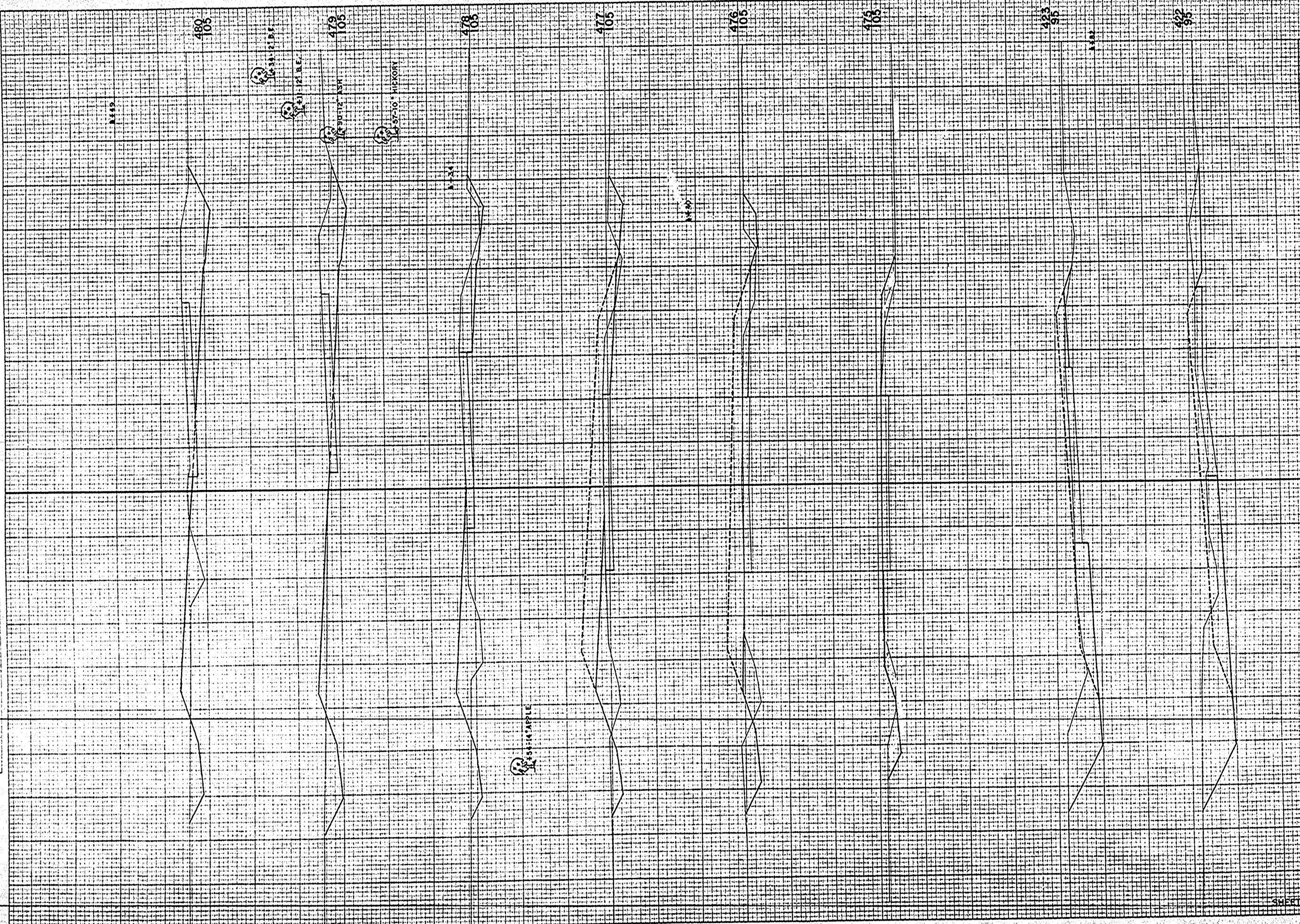

STATION	DISTANCE	YARDASE	
		EXCAVATION	FILL
422		350	0
423		288	2
424		115	2
474		9	11
475		46	39
476		78	82
477		89	117
478		141	93
479		198	67
480			
SHEET TOTAL		963	409

FINAL SURVEY
 DATE: 10/15/50
 NOTE BOOK NO. 10650

ORIGINAL SURVEY
 DATE: 10/15/50
 NOTE BOOK NO. 10650

D.P.R. DISTRICT OFFICE
 WIS. 4
 PROJECT 3 1200 (2)
 SHEET NUMBER 14
 TOTAL SHEETS 16

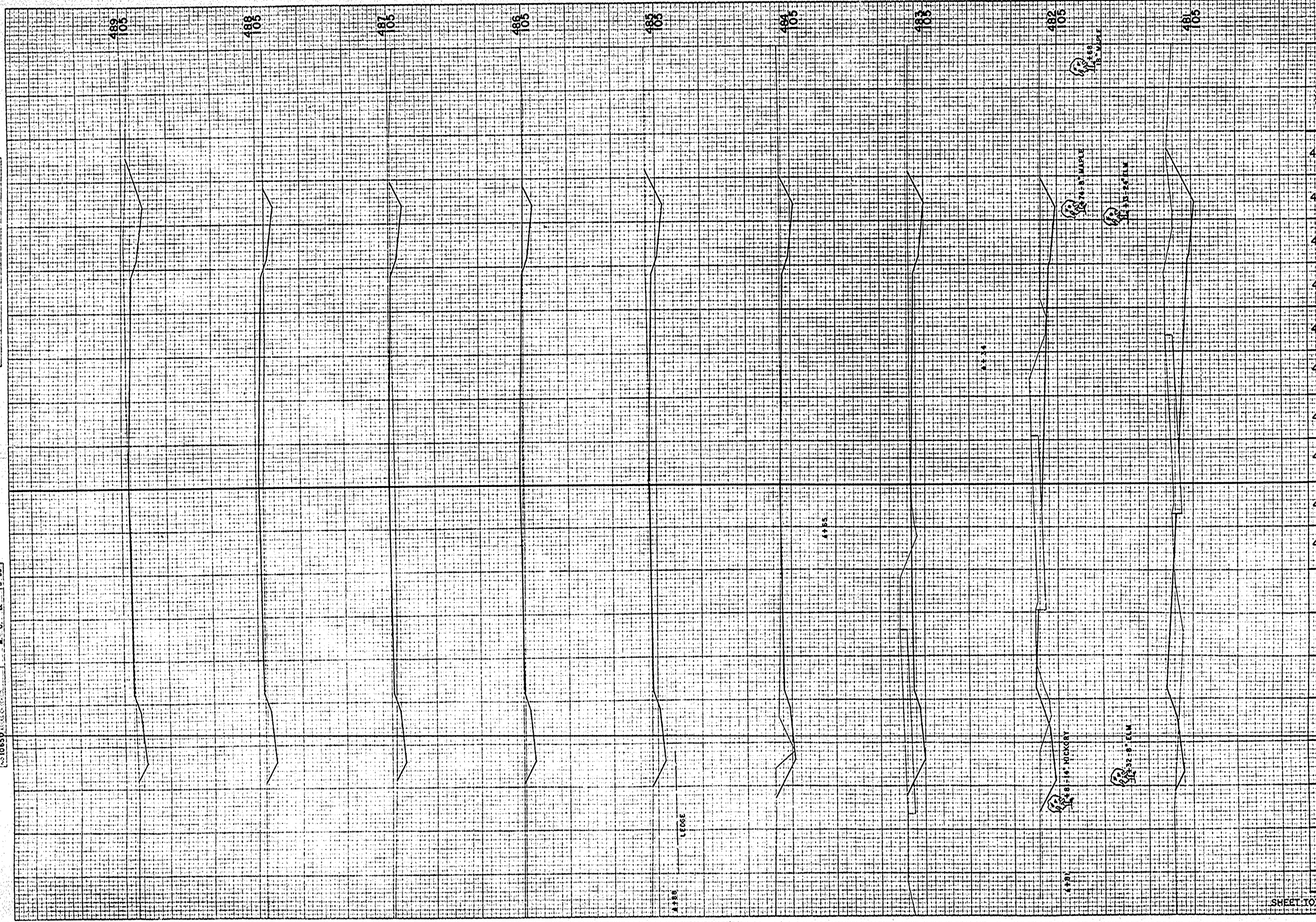

STATION	YARDAGE	
	EXCAVATION	FILL
480	215	72
481	191	43
482	165	11
483	139	4
484	113	2
485	87	13
486	54	44
487	46	67
488	82	35
489		
SHEET TOTAL	1092	291

FINAL SURVEY SHEET

ORIGINAL SURVEY SHEET NO. 10850

498
100

497
100

496
100

495
100

494
100

493
100

492
100

491
100

490
100

D.P.R. DISTRICT OFFICE	PROJECT	SHEET NUMBER	TOTAL SHEETS
WIS. 4	S 1255 (2)	15	16

STATION	DISTANCE	YARDAGE	
		UNCL.	FILL
489			
490	72		89
491	33		185
492	39		257
493	26		317
494	11		367
495	15		341
496	63		239
497	65		146
498	24		39
Subtotal		249	1860

